

DIOCESAN ADVISORY COMMITTEE

SCHEDULE OF DOCUMENTS

1. **Statement of Significance** (Statement of Significance_ASKL_0714.pdf)
2. **Statement of Needs** (Statement of Needs Lady Chapel FINAL 191020.pdf)
3. **Plan of the church** (All Saints Church Kings Langley - Plan.pdf)
4. **Picture 1 of the existing Chapel** (ASKL_Lady Chapel IMG_2630.jpg)
5. **Picture 2 of the existing Chapel** (ASKL_Lady Chapel IMG_2634.jpg)
6. **PCC resolution** (ASKL_PCC_Minutes_29_09_2020_redacted.pdf)
7. **See Paragraph 14** (King's Langley, All Saints - October 2020.pdf)
8. **Response to DAC visit Paragraph 14** (Mock Up of Altar Frontal Lady Chapel 121120 Final.pdf)
9. **Altar frontal detail - Fabrics, design and maker** (ASKL Lady Chapel Altar frontal detail.docx)

TO THE CHANCELLOR OF
THE DIOCESE OF ST ALBANS

01/12/2020

VIEWED by the St Albans Diocesan
Advisory Committee

ALL SAINTS CHURCH KINGS LANGLEY

HERTFORDSHIRE

Statement of Significance

Grade II* Listed building

KINGS LANGLEY

Parish church. Chancel C13, nave earlier but largely altered by building of C14 N aisle and its subsequent early C15 alteration to arcade when S aisle and S chapel rebuilt. Later C15 N chapel and tower.



1878 NE chapel built for C14 tomb of Edmund of Langley. 1894 choir vestry and N porch. Partly restored 1899 (clerestory and top of tower).

Large polygonal church room, etc. linked on S 1976.

Flint with dressings of Tottenhoe stone. Steep red tile roofs. Largely Perp. church much restored, consisting of stocky W tower with diagonal buttresses battlements and spike, 3-bay nave with aisles and clerestory, lower chancel flanked by chapels with NE chapel and SE vestry in line with E end of chancel.

The Chancel has a C13 double piscina with shelves, W window of 1877 in C15 style, 2-bay C15 4-centred arcade on N with engaged shafts opening to N chapel, a 2-bay early C15 S arcade with octagonal piers, jamb of C13 lancet window to E,

A late C19 chancel arch, and an elaborate carved alabaster reredos of 1878 designed by Joseph Clarke.

The N chapel has 2 late C15 square headed N windows each of 4 cinquefoil lights and one small window, a carved wooden screen to N aisle, in a C19 raised part at E the late C14 altar tomb of Edmund of Langley, son of Edward III, moved from the dissolved Friary church c.1539 to the chancel of this church and in 1878 to this specially built chapel, Queen Victoria presenting the armorial E window. This tomb has alabaster sides on a Purbeck marble plinth with carved shields on 3 sides (painted heraldically on W face). The present top slab is part of an altar with 3 of its 5 crosses; what may be the original slab is set in the floor of the N chapel with an indent of a woman's figure, near some medieval encaustic floor tiles.

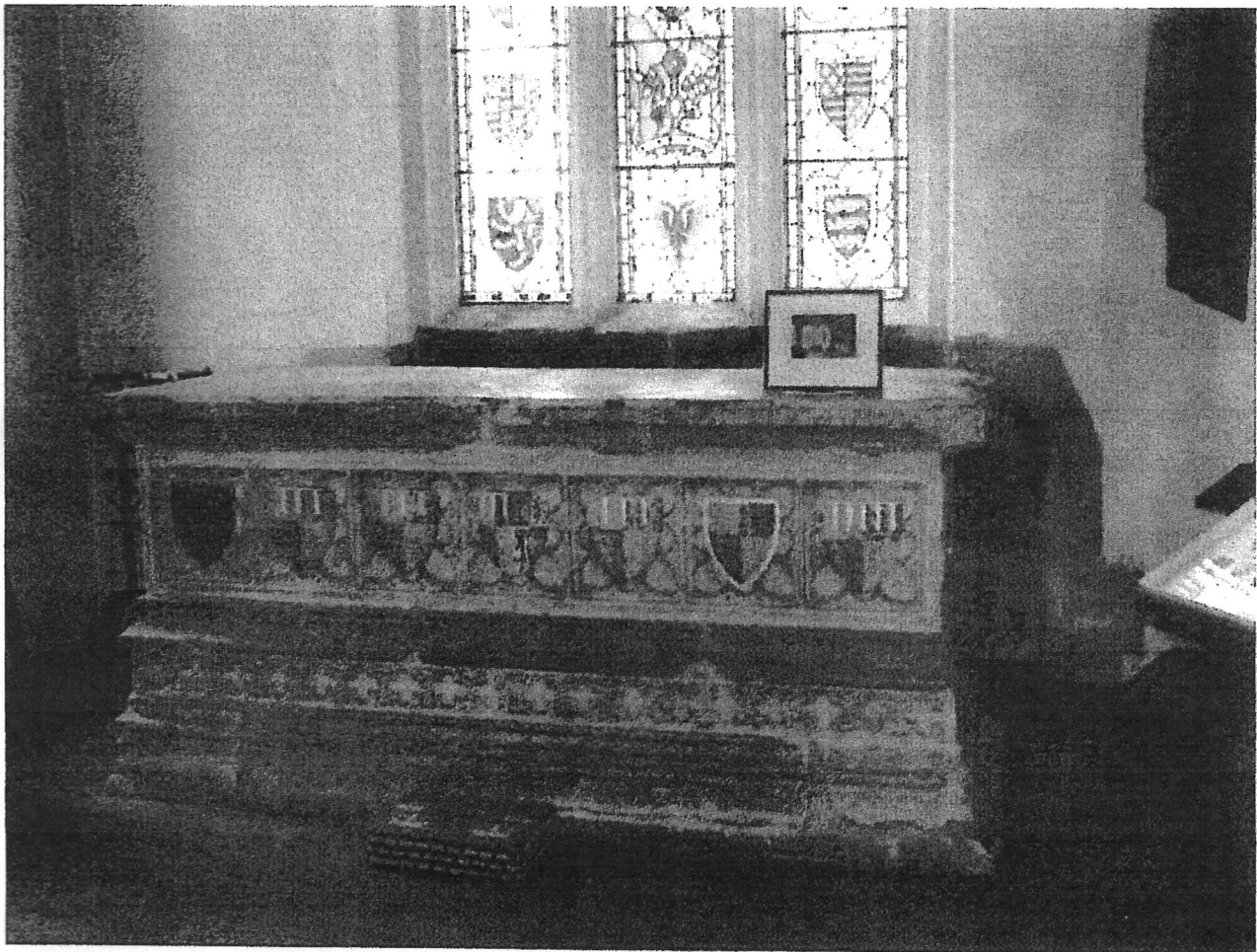

In the same chapel the chest tomb of Sir Ralph Verney d.1528 and wife with effigies, brass of John Carter d.1588 with 2 wives, 9 sons and 9 daughters.

Queen Victoria Memorial Window 1901 by Clayton & Bell, and some fragments of old heraldic glass from former E window of N chapel. The S chapel is largely occupied by the organ which hides a piscina. C19 W window but C15 S window of 4 lights. Large stone memorial on N wall to Mary Elizabeth Crawford d.1793 signed 'Bonomi inv Westmacott sculp' with small medallion,

weeping putto and garlands. 3-bays nave with early C15 arcades and clerestory of 6 2-light windows rebuilt in late C19.

Hexagonal early C17 panelled and carved oak pulpit with tester and elaborately carved back. Tower arch late C15. The N aisle has a 2-light Dec W window c.1340 and the N wall may be of similar date. 2 square headed N windows with renewed tracery of 3 trefoil-headed lights. N doorway with continuous moulding. The S aisle has a C13 piscina, a S window of 3 cinquefoil-headed lights and a C15 S doorway with continuous moulding.

Stained glass of Mary and Martha by Ward & Hughes 1876. Late C19 W window.

3-stage W tower with renewed W door, 3-light C15 W window within blocked arch of a larger window. 2-light trefoil-headed N and S windows. 4 C15 bell chamber openings similar.

Buttresses much repaired with tiles in SPAB technique.

Stained glass W window by Powell 1908.

Extension to south comprising octagonal hall,,meeting room toilets etc added in 1970,s



Extensive, closed churchyard

South vestries refurbished in 2008 with mezzanine level added by Michael Dales Partnership. West slope of vestry roof re-roofed in stainless steel following lead theft in 2010.

Refs;

(RCHM(1911)133-4: Kelly(1914) 170: VCH(1908)242-3:

Pertness – Buildings of England - Hertfordshire

Michael Dales Partnership Limited

July 2014

Michael Dales Partnership
Architecture & Design

ALL SAINTS CHURCH KINGS LANGLEY

STATEMENT OF NEED 2020 – Lady Chapel

All Saints Parochial Church Council (PCC) has resolved to enhance the existing Lady Chapel. Pictures of the Lady Chapel are attached to the application and reproduced here:



The principal function of the Lady Chapel is as a memorial at present. The existing mobile altar table was donated by an existing church member. There is little use of the chapel at present for ministry and worship.

It is now felt that an enhanced Lady Chapel could provide an opportunity for a more intimate form of ministry, worship, prayer and reflection.

This would be achieved by covering the existing bare wooden table with an altar frontal and providing a focal point with the statuary.

The Lady Chapel would form a much more appropriate setting for small services such as the Sunday 8am Communion or midweek services. All of these currently take place in the chancel and make use of the choir stalls for seating, which is an awkward setting for the congregation to see, hear and participate. It is also the natural place in the building to offer quiet prayer and reflection after worship on a Sunday and for visitors throughout the week. For both these aspects, the area would benefit from being better highlighted as a chapel for prayer and worship, and not only for remembering. It currently lacks any symbols or visual cues that it is the Lady Chapel.

Altar frontal and cloths

The Altar frontal would be decorated with gold work (see example below) and the altar cloths embroidered.

This image is an example of what the finished altar frontal will look like.

There will be a super frontal along the top to finish it.



Statuary



Our Lady of Walsingham

11½ inches

<https://shop.walsingham.org.uk/collections/statues/products/our-lady-of-walsingham-statue>

PCC Resolution

A resolution was passed at the PCC meeting on 29th September, 2020, copy attached as a supporting document, with the relevant item reproduced as:

Lady Chapel

Work proposed for this area needs a PCC resolution for a faculty. There was a proposal for an altar cloth, a choice of statues and a votive candle stand. Lynne requested that we focus on the altar cloth and statuary first and retain the votive candle stand. Fr. James therefore proposed to improve the decorations in the Lady Chapel by creating a new altar frontal at an estimated cost of £288 for materials (to be produced by volunteers) and an 11.5 inch statue of Our Lady of Walsingham at a cost of £125. Brian seconded the proposal and all were in favour.

ACTION: PS & CC

hkhina
PCC Secretary
12/10/20

Price estimate:

Item	Cost
Altar frontal and cloths	
2 metres St Margaret Brocade, blue/gold*	£140.00
1 metre St Margaret Brocade, blue*	£70.00
2 metres + of gold braid (example below)*	£14.00
2 metres metallic fringe (example below)*	£39.00
Altar cloths**	£17.00
Hessian**	£8.00
Sub total	£288.00
Statuary	
Our Lady of Walsingham	£125.00
Grand Total:	£413.00

*Sourced from FM Church Supplies (www.fmchurchsupplies.com)

** From local haberdashery shop

Labour gratis.

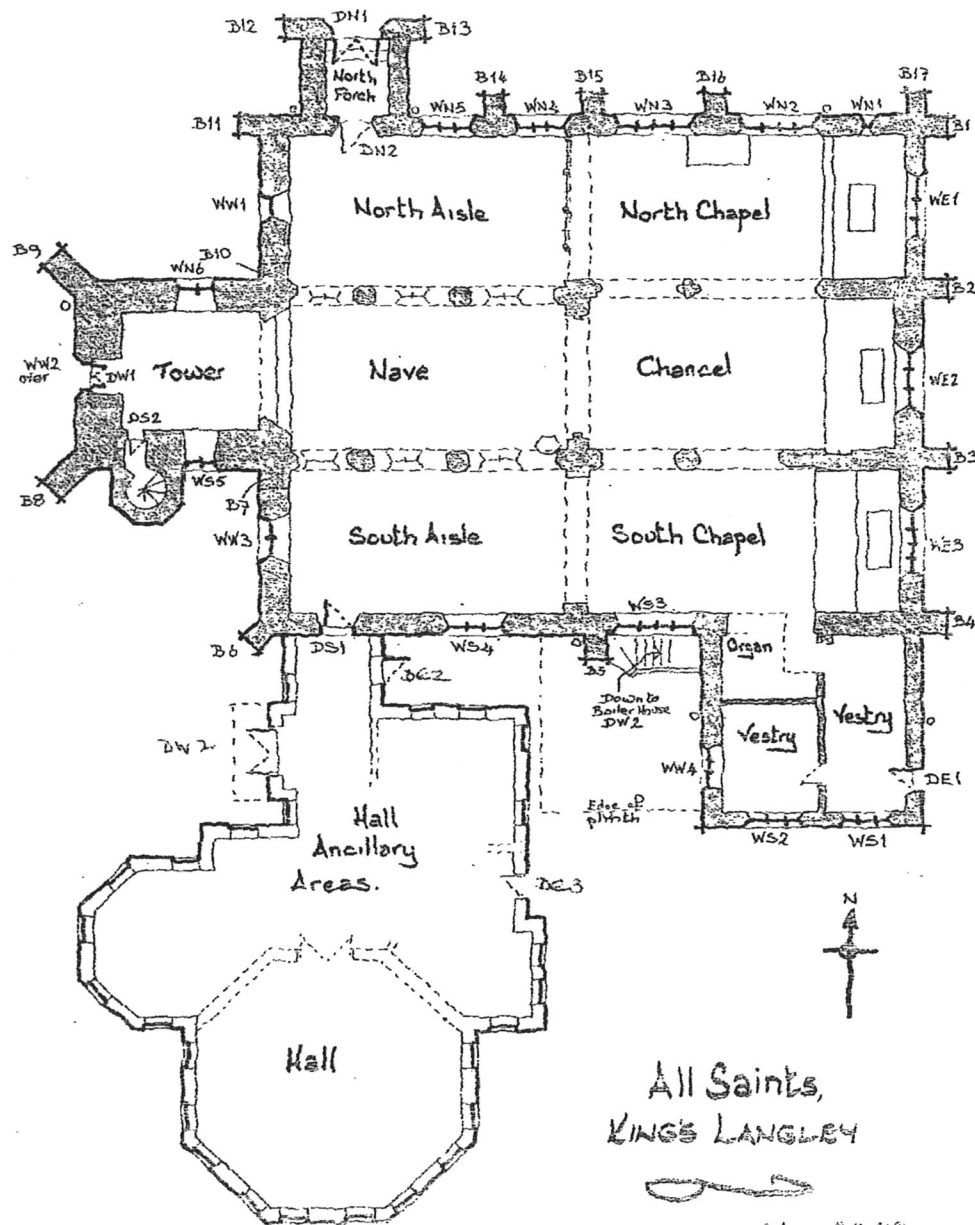





All Saints' Church, King's Langley

In the Benefice of Langelei

MINUTES OF THE PAROCHIAL CHURCH COUNCIL
MEETING HELD ON TUESDAY 29 SEPTEMBER 2020 at 8.00 p.m.

Online via Zoom during the Coronavirus pandemic

Present:

Fr. James McDonald (Chairman), Brian McAdam, Peter Sutcliffe, Sheila Ashman, Patricia Humberstone, Lynne Head, Clare Gilden, Eric Martin, Susan Brazier, Lyndsay Jepsen, Clare China (Secretary)

1. Opening Prayer led by Fr. James

2. Apologies for absence: Sheila Peevers, Keith Gower, Ingrid Allen, Carolyn Andrews

3. Minutes of the meeting held on 30 July 2020

Lynne proposed approval of these minutes, Patricia seconded and all agreed. These will be signed by the Chairman.

4. Matters arising from the minutes of 30 July 2020 (other than those included on this agenda)

- **Replacement Church Open Flag** has been delivered.
- **Hall Use**
Ingrid, Patricia, James and Keith had worked on the Risk Assessment. The hall was now ready for people to return. There is a new group starting, but two groups had decided not to return.
- **Lady Chapel** has not progressed any further as yet.

5. Minutes of Standing Committee held on 23 August 2020

Eric proposed approval of these minutes, Lynne seconded all were in favour.

6. Matters arising from the minutes of the Standing Committee

No matters arising.

7. Vicar's Report (previously circulated)

Fr. James presented his report, highlighting the following:

- **All Souls** – Sheila A. and Brian volunteered to staff the church on Saturday 31 October during the afternoon when it will be open for people to remember loved ones in lieu of the usual service. **ACTION: SA & BMc**
- **All Saints Day** – James suggested a virtual parish lunch on Sunday 1 November using it as a time to reflect on our MAP and new ideas for the ongoing Covid situation.
- **Remembrance Sunday 8 November** – the village remembrance service will be held outside at 3.00 p.m.
- **APCM** – will be held on Sunday 11 October in person in church after the service or online via Zoom.

8. Treasurer's Report (previously circulated)

9. Fundraising & Stewardship

Brian reported there had been a very successful stewardship campaign with positive responses and Eric reporting some increases in payments. There is not likely to be a huge amount made with fundraising between now and the end of the year. Thanks were expressed to Ingrid for co-ordinating the market stall. Brian also said the Friends of All Saints will be organising a virtual quiz (date to be confirmed) and we need people to sell tickets.

10. Fabric Report (previously circulated)

Peter presented his report and discussed the following items:

Archives

Peter reported that he and Colin had made great progress sorting out papers in the mezzanine. The documents in the safe now need to be sorted out as to which are going to archive. There were lots of old magazines in a drawer, but local content is minimal, so should they be kept, archived or binned? There are many photos and photo albums which show the history of All Saints. These need to be collected together and kept carefully for the future. There are boxes labelled "Rectory" which James needs to sort. Lynne wondered if the photos could be digitised on a selected basis for certain events. James thought this was a good suggestion and Lynne believed she would be able to start this task with the more important photos. Lynne will contact Peter to meet up to discuss. James needs to make a decision about the certificates in the safe. Sheila believed we should dispose of the magazines, but Peter suggested the Museum Society might take them. James suggested Peter should offer them to the Museum Society but otherwise dispose of them and move on. **ACTION: JMc, LH, PS**

Church Guide – is in draft form ready for publishing as and when we want to move forward with it.

Office Hatch – James and Peter will meet with Norma about this.

ACTION: JMc & PS

Heating – we now know what is needed for improvement following the report from heating specialist, James Sheehan, but this is a big decision which will be taken in conjunction with reordering.

Churchyard – there had been no response to the public notices. At the end of the month we can write to the local authority to request it to make the memorials safe.

Memorials

A PCC decision needs to be made about which proposal to accept. It was agreed that the post and rail threefold system to the right of the main entrance to the church would work well. All agreed that Peter should ask Michael Dales to work on this idea. **ACTION: PS**

Lady Chapel

Work proposed for this area needs a PCC resolution for a faculty. There was a proposal for an altar cloth, a choice of statues and a votive candle stand. Lynne requested that we focus on the altar cloth and statuary first and retain the votive candle stand. Fr. James therefore proposed to improve the decorations in the Lady Chapel by creating a new altar frontal at an estimated cost of £288 for materials (to be produced by volunteers) and an 11.5 inch statue of Our Lady of Walsingham at a cost of £125. Brian seconded the proposal and all were in favour. **ACTION: PS & CC**

11. Team Council Report

Nothing to report as there had been no meeting.

blhina
PCC Secretary
12/10/20

12. Deanery Report

James reported the Deanery Chapter had met today with the Archdeacon but the Deanery Synod has not met.

13. Safeguarding Report

Lynne presented her report. Lynne will provide a QR code for people to scan in church. Lynne believes there are more people needing safeguarding training and will have a chat to the wardens about it.

ACTION: LH

14. LMDT (Pastoral Team)

There had been no meeting but James will send out dates for October to the pastoral team to catch up. Eric reported that further people had been recruited into the Welcomers team. Brian proposed thanks to Sheila for organising the rotas over the pandemic period.

ACTION: JMc

15. Any Other Business -

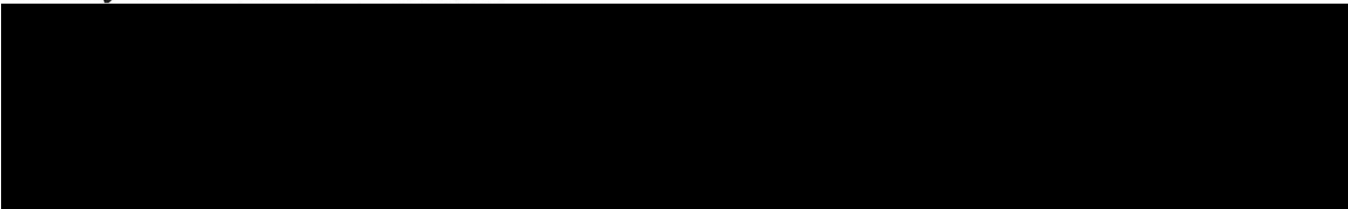

- Sue reported that the Cricket Club were happy for All Saints to use the green on a Sunday for a match with tea.

The meeting closed at 9.15 p.m.

Date of Next Meeting
APCM Sunday 11 October

VISIT TO THE CHURCH OF ALL SAINTS, KING'S LANGLEY: 27 OCTOBER 2020

Purpose of Visit: *Reordering plans*

Extract of the meeting notes – item 14 concerning the South Chapel application:

Lady Chapel (south chapel) and organ

14. The parish had put forward outline proposals to enhance the use of the Lady Chapel for worship. At present, the panelled sanctuary contained the Book of Remembrance, the War Memorial and its associated flags. A piece of material thought to be part of the frontal for the previous altar (which was perhaps fixed to the east wall panelling) had been set onto the panelling as a backdrop to a small, uncovered movable altar that had served as a hymn book trolley in recent memory. The plan was to provide the altar with a new frontal in a gold and blue design. Fears that this would make the chapel seem dark were unfounded, as the clear east chapel window made the chapel one of the lightest parts of the building. The visitors looked forward to seeing more details of the frontal design and any associated proposals, such as rehangings the flags at high level and relocating the Book of Remembrance. The PCC could also investigate the provenance and any historic or artistic significance of the fabric panel and consider whether to retain it.

ALL SAINTS CHURCH KINGS LANGLEY

Lady Chapel - Altar Frontal Mock Up

DAC request for further information as per the recent visit report (AC/20/18 drafted 30/10/2020) - item 14 is reproduced as:

14. The parish had put forward outline proposals to enhance the use of the Lady Chapel for worship. At present, the panelled sanctuary contained the Book of Remembrance, the War Memorial and its associated flags. A piece of material thought to be part of the frontal for the previous altar (which was perhaps fixed to the east wall panelling) had been set onto the panelling as a backdrop to a small, uncovered movable altar that had served as a hymn book trolley in recent memory. The plan was to provide the altar with a new frontal in a gold and blue design. Fears that this would make the chapel seem dark were unfounded, as the clear east chapel window made the chapel one of the lightest parts of the building. The visitors looked forward to seeing more details of the frontal design¹ and any associated proposals², such as rehanging the flags at high level and relocating the Book of Remembrance. The PCC could also investigate the provenance and any historic or artistic significance of the fabric panel and consider whether to retain it³.

1. Detail of the frontal design:

Pictures of the Lady Chapel altar table, both as is, and as proposed (mock-up), are overleaf.

The graphic representation accuracy is subject to the limits of both the software and the author's skill! We hope that the visual mock up shows the design intent.

2. Associated Proposals

No further changes are proposed at the present time other than the addition of a statue, details as per the earlier submission via DAC portal.

The flags associated with the war memorial are already elevated and are situated either side of the memorial tablet. There was some discussion at the DAC visit about rehanging the flags horizontally, at a higher level elsewhere in the chapel so as to free up the war memorial. If pursued, this would be the subject of a separate application at a later date.

The Book of Remembrance is housed in a portable display case and has historically been displayed in various positions within the Lady Chapel.

3. Fabric Panel

None of the records in the possession of the PCC provide any further enlightenment on the presence of the fabric panel (see existing arrangement photograph overleaf). There is no reference to the panel in Haythornthwaite⁴; 1924.

Given that the new frontal will largely obscure the view of this panel it is proposed to leave it as it is.

4. Haythornthwaite; The Parish of Kings Langley: Its Ancient Church and its Historic Associations; 1924.

Existing Lady Chapel Altar



Proposed Altar Frontal



All Saints Church, Kings Langley – Lady Chapel Altar Frontal Detail

Altar Frontal Fabrics

(as per images below) Sourced from FM Church Supplies (www.fmchurchsupplies.com)

Main fabric: Blue/gold St Margaret brocade.

Centre panel and super frontal: Blue St Margaret brocade and gold braid.

Bottom of frontal: Gold fringing.



NB: Colour representation is more 'true' on the image below.

Altar Frontal Design

Dimensions:

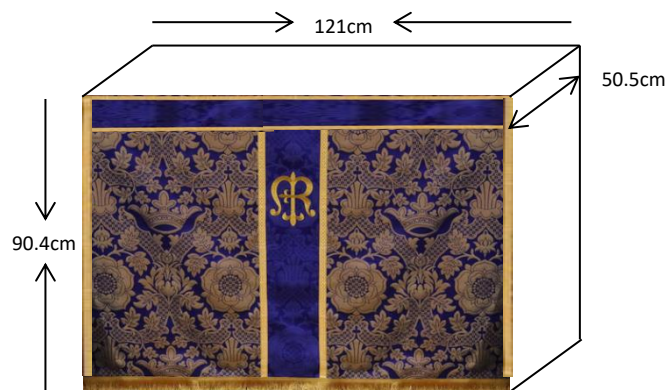

The centre panel of the altar frontal will be embroidered with "Maria Regina" symbol in gold work (edging: gold work purl wire, gold work embroidery thread, backing fabric and wadding). The images below are representative of the finished embroidery. We have included the drawing to show the design in greater detail:



There will be a plain white 100% cotton altar cloth embroidered with small white work crosses at each corner (see image below), a 'fair' cloth and a dust cover (both of white polyester cotton).

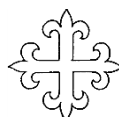

The makers

The work will be carried out by a project team of experienced needle-workers led by Lynne Head (PCC member and Safeguarding Coordinator). Lynne has a Diploma in Embroidery (Distinction).